

Studded Power Feed Thru Terminal Blocks

ST722 Series

The Studded Power Feed Thru Terminal Blocks were designed for applications where power feed thru is necessary using standard double hole lugs with .625" spacing.

These terminal blocks are available in three mounting options (end mount, back mount, and slide-in mount). They are also offered in various line lengths and with various hardware options (See Hardware Descriptions Below).

These terminal blocks lower cost by eliminating multiple components and assembly time. The terminal blocks are manufactured from top quality insulator and conductor materials. They are designed with a robust one-piece insulator base using a one-piece conductor permanently assembled together.

Covers are molded using a one-piece design and are available as an option for all three series of these blocks.

Series	Mounting	Stud (Thread Size)		Poles		Hardware	
ST722	B	2	5	0	2		
	B – Back Mount S – Slide Mount E – End Mount	19 - #10-32 Stud 25 - 1/4" - 20 Stud M5 - M5 Stud M6 - M6 Stud		(Back Mount) 02 – 06 (Slide Mount) 01 – 04 (End Mount) 01 – 06		(blank) – No hardware UH – All nuts shipped bulk AH – All nuts assembled DL – Assembled barrier side, remainder shipped bulk	

Optional Cover Available:

- Cover is offered in 1 – 6 poles
- One cover accommodates all series
- Base, Thermoplastic
- Flammability UL 94 V-0

Catalog Number	Number of Poles	Dimensions A	
		Inches	Metric
C72201	1	0.91	(23.11)
C72202	2	1.64	(41.66)
C72203	3	2.37	(60.20)
C72204	4	3.10	(78.74)
C72205	5	3.83	(97.28)
C72206	6	4.56	(115.82)

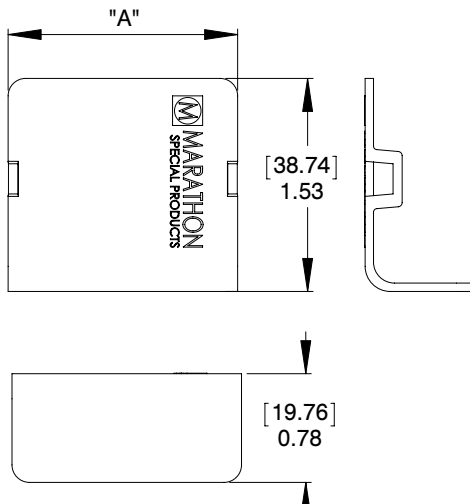

For electronic drawings or 2D/3D CAD data, submit request at www.marathonsp.com/drawings.html

Studded Power Feed Thru Terminal Blocks

ST722B Series (back mount)

Specifications:

Electrical:

- 300 Volts AC/DC (UL 1059 Class B and C)
- 175 Amps
- Wire Range 2/0 - #8
- Accommodates Two Hole Compression Lugs on .625" Centers – wires #2 and larger may require narrow lugs

General/Mechanical:

- Base, Thermoplastic, 125°C (UL RTI)
- Studs, Brass, Nickel Plated
- 2 – 6 Poles
- .73" Centers
- Application Torque: 35 lbf-in for #10 - 32 and M5, 50 lbf-in for 1/4" - 20 and M6
- UL Recognized File No. XCFR2.E62806
- CSA Certified File No. LR19766
- CE
- RoHS Compliant



ST722B2502

LENGTH	"P"	
	ENG.	MET.
2-LINE	1.35	34.3
3-LINE	2.08	52.8
4-LINE	2.81	71.4
5-LINE	3.54	89.9
6-LINE	4.27	108.5

Catalog Number	Number of Poles	Dimensions A	
		Inches	Metric
ST722BXX02	2	1.55	(39.37)
ST722BXX03	3	2.28	(57.91)
ST722BXX04	4	3.01	(75.45)
ST722BXX05	5	3.74	(95.00)
ST722BXX06	6	4.47	(113.54)

Replace XX with thread size:
 19 - #10-32 Stud
 25 - 1/4" - 20 Stud
 M5 - M5 Stud
 M6 - M6 Stud

Hardware Options:
 (blank) – No hardware
 UH – All nuts shipped bulk
 AH – All nuts assembled
 DL – Assembled barrier side, remainder shipped bulk

See page 60 for available covers

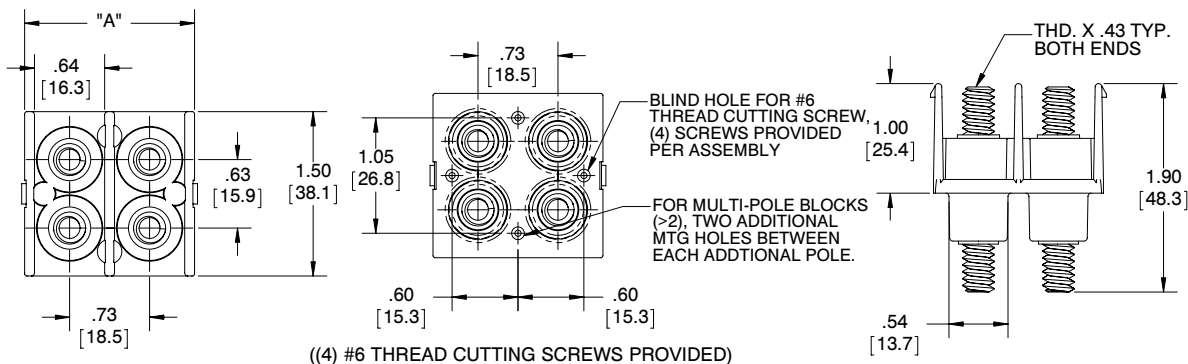
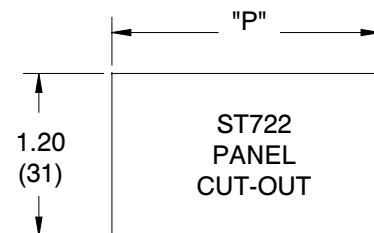

For electronic drawings or 2D/3D CAD data, submit request at www.marathonsp.com/drawings.html

Datasheets available at marathonsp.com

Studded Power Feed Thru Terminal Blocks

ST722S Series (slide-in mount)

Specifications:

Electrical:

- 300 Volts AC/DC (UL 1059 Class B and C)
- 175 Amps
- Wire Range 2/0 - #8
- Accommodates Two Hole Compression Lugs on .625" Centers – wires #2 and larger may require narrow lugs

General/Mechanical:

- Base, Thermoplastic, 125°C (UL RTI)
- Studs, Brass, Nickel Plated
- 1 - 4 Poles
- .73" Centers
- Application Torque: 35 lbf-in for #10 - 32 and M5, 50 lbf-in for 1/4" - 20 and M6
- UL Recognized File No. XCFR2.E62806
- CSA Certified File No. LR19766
- CE
- RoHS Compliant



ST722S2502

Catalog Number	Number of Poles	Dimensions A	
		Inches	Metric
ST722SXX01	1	0.82	(20.83)
ST722SXX02	2	1.55	(39.37)
ST722SXX03	3	2.28	(57.91)
ST722SXX04	4	3.01	(76.45)

Replace XX with thread size:
 19 - #10-32 Stud
 25 - 1/4" - 20 Stud
 M5 - M5 Stud
 M6 - M6 Stud

Hardware Options:
 (blank) – No hardware
 UH – All nuts shipped bulk
 AH – All nuts assembled
 DL – Assembled barrier side, remainder shipped bulk

See page 60 for available covers

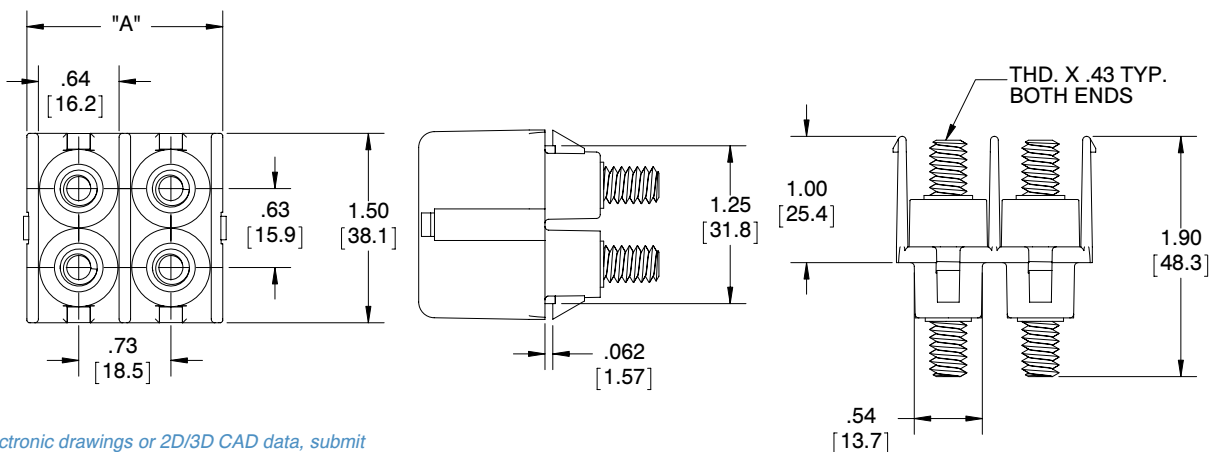

For electronic drawings or 2D/3D CAD data, submit request at www.marathonsp.com/drawings.html

Studded Power Feed Thru Terminal Blocks

ST722E Series (end mount)

Specifications:

Electrical:

- 300 Volts AC/DC (UL 1059 Class B and C)
- 175 Amps
- Wire Range 2/0 - #8
- Accommodates Two Hole Compression Lugs on .625" Centers – wires #2 and larger may require narrow lugs

General/Mechanical:

- Base, Thermoplastic, 125°C (UL RTI)
- Studs, Brass, Nickel Plated
- 1 - 6 Poles
- .73" Centers
- Application Torque: 35 lbf-in for #10 - 32 and M5, 50 lbf-in for 1/4" - 20 and M6
- UL Recognized File No. XCFR2.E62806
- CSA Certified File No. LR19766
- CE
- RoHS Compliant



ST722E2503

LENGTH	"P1"	"P2"
1-LINE	1.32	.66
2-LINE	2.05	1.39
3-LINE	2.78	2.12
4-LINE	3.51	2.85
5-LINE	4.24	3.58
6-LINE	4.97	4.31

Catalog Number	Number of Poles	Dimensions A		Dimensions B	
		Inches	Metric	Inches	Metric
ST722EXX01	1	1.32	(33.53)	1.77	(44.96)
ST722EXX02	2	2.05	(52.07)	2.50	(63.50)
ST722EXX03	3	2.78	(70.61)	3.23	(82.40)
ST722EXX04	4	3.51	(89.15)	3.96	(100.58)
ST722EXX05	5	4.24	(107.70)	4.69	(119.13)
ST722EXX06	6	4.97	(126.24)	5.42	(137.67)

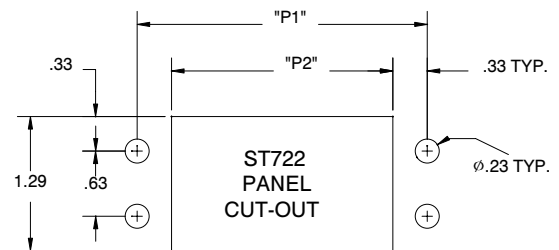

Replace XX with thread size:
 19 - #10-32 Stud
 25 - 1/4" - 20 Stud
 M5 - M5 Stud
 M6 - M6 Stud

Hardware Options:
 (blank) – No hardware
 UH – All nuts shipped bulk
 AH – All nuts assembled
 DL – Assembled barrier side,
 remainder shipped bulk

See page 60 for available covers

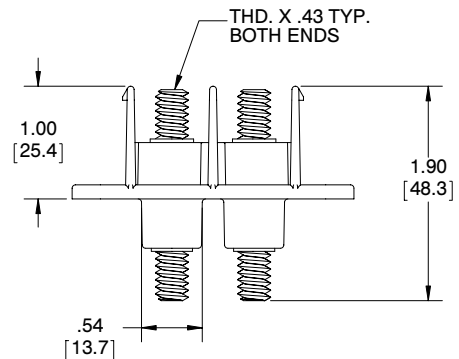
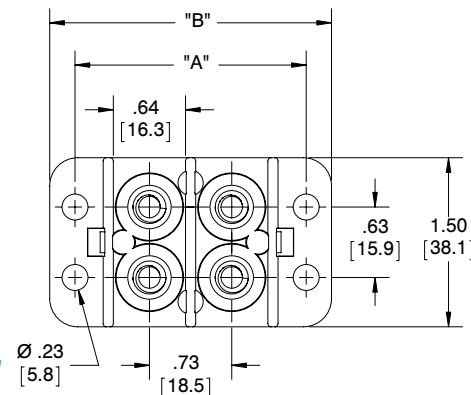

For electronic drawings or 2D/3D CAD data, submit request at www.marathonsp.com/drawings.html

Studded Power Feed Thru Terminal Blocks

ST715S1902

Specifications:

Electrical:

- 300 Volts AC/DC (UL 1059 Class B and C)
- 80 Amps
- Wire Range #6 - #14
- Accommodates Two Hole Compression Lugs on .625" Centers

General/Mechanical:

- Base, Thermoplastic, 125°C (UL RTI)
- Studs, Brass, Nickel Plated
- 2 Poles
- .56" Centers
- Application Torque: 35 lbf-in
- UL Recognized File No. XCFR2.E62806
- cURus Certified File No. XCFR8.E62806
- CE
- RoHS Compliant

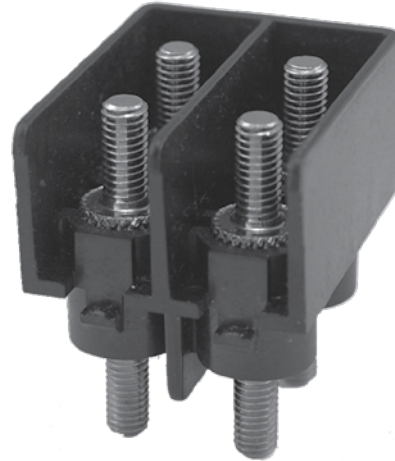

ST715S902

Hardware Options:

- (blank) – No hardware
- UH – All nuts shipped bulk
- AH – All nuts assembled
- DL – Assembled barrier side, remainder shipped bulk

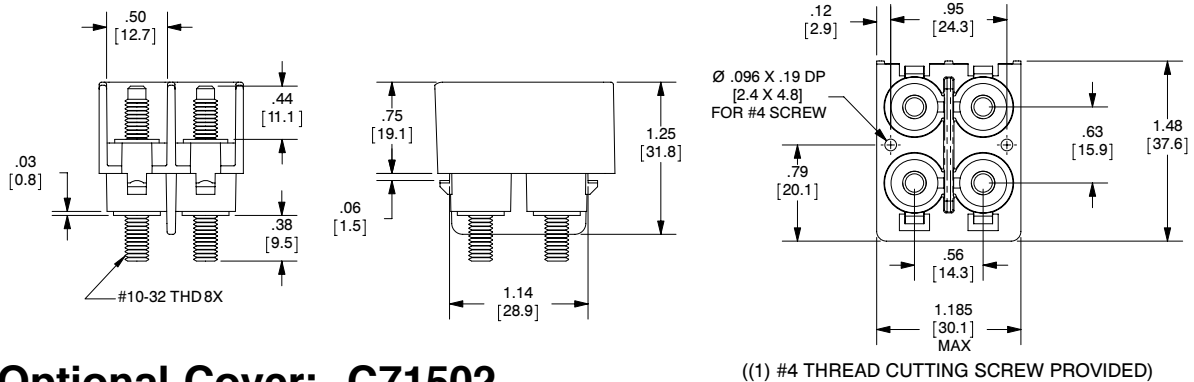

Optional Cover: C71502

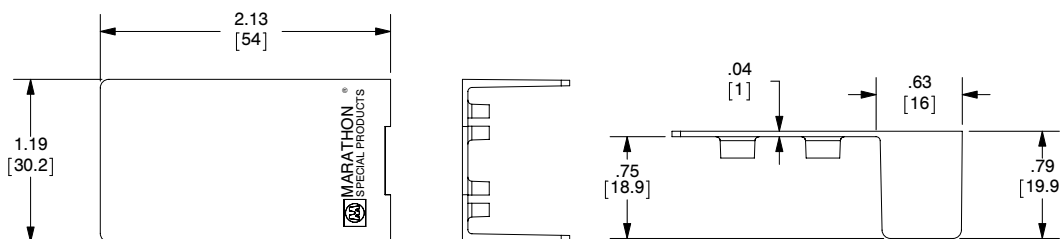

For electronic drawings or 2D/3D CAD data, submit request at www.marathonsp.com/drawings.html

Studded Power Feed Thru Terminal Blocks

ST723B38 Series (back mount)

Specifications:

Electrical:

- 600 Volts AC/DC (UL 1059 Class B and C)
- 380 Amps
- Wire Range 500 kcmil - 2/0 AWG
- Accommodates Two Hole Compression Lugs on 1" Centers - wires larger than 250 kcmil require narrow lug

Mechanical:

- Base, Thermoplastic, 125°C (UL RTI)
- Flammability, UL 94 V-O
- Studs, 3/8" - 16, Brass, Nickel Plated
- Mounting hardware included (4) #10-32 Screws
- Application Torque: 192 lbf-in
- UL Recognized File No. XCFR2.E62806
- cURus Certified File No. XCFR8.E62806
- RoHS Compliant



ST723B3802

Hardware Options:

- (blank) – No hardware
- UH – All nuts shipped bulk
- AH – All nuts assembled
- DL – Assembled barrier side, remainder shipped bulk

ST723B3801 - One Pole

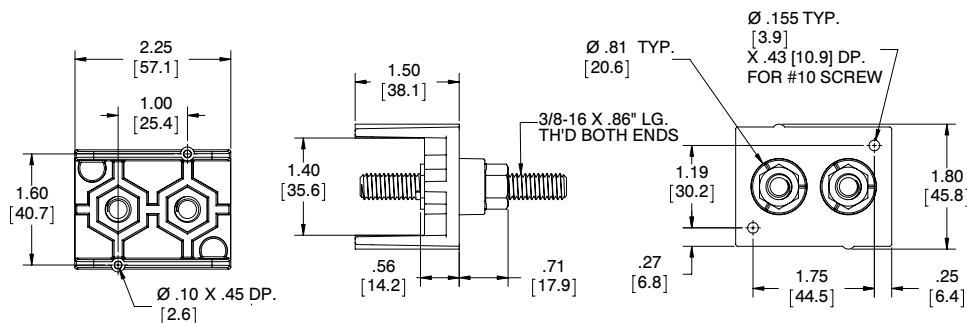

ST723B3802 - Two Poles

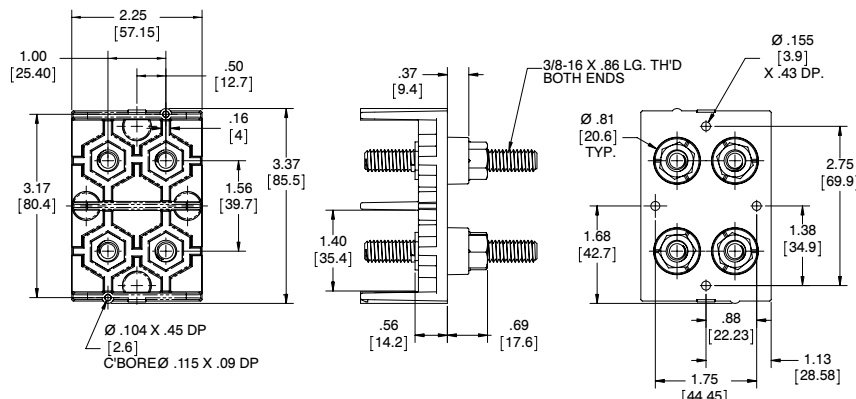

For electronic drawings or 2D/3D CAD data, submit request at www.marathonsp.com/drawings.html