

# Product Data Sheet



## FPB23570

Listed Power Distribution Block  
175 Amps, 600 Volts (AC/DC)



### Wire Range:

Line side: (1) 2/0 - #14 AWG

Load Side: (4) #4 - #14 AWG

See tables below for SCCR wire ranges and multiple wire approvals.

### Electrical Ratings:

- 175A copper wire, 135A aluminum wire (Based on NEC Table 310-16, 75°C columns)
- 600 Volts AC/DC (Service Equipment according to National Electrical Code, NFPA 70)
- Minimum enclosure size: 16 X 12 X 6
- Factory and Field Wiring

### Short Circuit Current Ratings (Copper wire only):

| Suitable Conductors<br>(kcmil/AWG) |        | Overcurrent Protection Fuse Required<br>Class/Max Amp Rating |     |     |     |    |    | SCCR, RMS<br>SYM Amps | Volts<br>Max |
|------------------------------------|--------|--|-----|-----|-----|----|----|-----------------------|--------------|
| Line                               | Load   | J  | T   | RK1 | RK5 | G  | CC |                       |              |
| 2/0 - 6                            | 4 - 14 | 200  | 200 | 200 | 100 | 60 | 30 | 100,000               | 600          |

|         |        | Overcurrent Protection Circuit Breaker Required |          |         | SCCR, RMS<br>SYM Amps | Volts<br>Max |
|---------|--------|---|----------|---------|-----------------------|--------------|
| Line    | Load   | Mfr   | Type     | Max Amp |                       |              |
| 2/0 - 2 | 4 - 8  | Square D  | JLL36250 | 250     | 65,000                | 480          |
| 2/0 - 4 | 4 - 8  | Allen Bradley                                   | 14OU-J6  | 250     | 50,000                | 480          |
|         |        |   | 14OU-JO  | 250     | 50,000                | 480          |
| 1/0 - 6 | 4 - 10 | Allen Bradley                                   | 14OU-H6  | 125     | 50,000                | 480          |
|         |        |   | 14OU-HO  | 125     | 50,000                | 480          |

### Mechanical Ratings:

- Maximum insulator base temperature: 125°C (257°F) UL RTI
  - Maximum insulator base plate temperature: 130°C (266°F) UL RTI
  - Flammability rating of insulator base and base plate: UL 94 V-0
- \* Use outside these ratings needs to be judged in the end-use application.

**Materials:**

- Connector: High conductivity aluminum, tin plated
- Insulator base: Glass filled polycarbonate (thermoplastic)
- Terminal set screws: Steel, nickel plated and aluminum, tin plated
- Connector mounting screw: Steel, zinc plated
- Insulator base plate: Phenolic laminate

**Agency Approvals:**

- UL Listed, File No. QPQS.E309401
- Investigated to UL 1953
- UL 508A Feeder Circuit Terminal Spacing for up to 600 Volts
- CSA Certified, CSA C22.2 No. 158, File No LR 19766
- 600V Rating for Class 6228 01 – Use Groups A, B, C
- CE compliant to IEC 60947-7-1
- RoHS Compliant

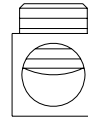

**Wire Approvals:**

**Line Side Wire Approvals:**

| Wire Size | Torque |         | Solid | Class B | Class C |
|-----------|--------|---------|-------|---------|---------|
|           | N.m    | in. lbs |       |         |         |
| 2/0 AWG   | 13.6   | 120     |       | 19      | 37      |
| 1/0       | 13.6   | 120     |       | 19      | 37      |
| 1         | 13.6   | 120     |       | 19      | 37      |
| 2         | 13.6   | 120     |       | 7       | 19      |
| 4         | 13.6   | 120     |       | 7       | 19      |
| 6         | 13.6   | 120     |       | 7       | 19      |
| 8         | 4.5    | 40      |       | 7       | 19      |
| 10        | 4.0    | 35      | 1     | 7       | 19      |
| 12        | 4.0    | 35      | 1     | 7       | 19      |
| 14        | 4.0    | 35      | 1     | 7       | 19      |

Aluminum stranded wire range: 2/0 – 14 AWG

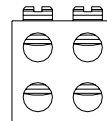

**Load Side Wire Approvals:**

| Wire Size | Torque |         | Copper Wire Stranding Classes - Number of Strands |          |           |
|-----------|--------|---------|---|----------|-----------|
|           | N.m    | in. lbs | Solid   | Class B  | Class C   |
| 4 AWG     | 4.0    | 35      |   | 7        | 19        |
| 6         | 4.0    | 35      |   | 7        | 19        |
| 8         | 4.0    | 35      |   | 7        | 19        |
| 10        | 4.0    | 35      | 1   | (1-2)* 7 | (1-2)* 19 |
| 12        | 4.0    | 35      | 1   | (1-4)* 7 | (1-4)* 19 |
| 14        | 4.0    | 35      | 1   | (1-4)* 7 | (1-4)* 19 |

\* Multiple conductor approvals for **LOAD** side only. (copper wire only)

Aluminum stranded wire range: 4 – 14

- Wire strip length, line side tap – 11/16"
- Wire strip length, load side tap, top row – 3/8", bottom row – 13/16"
- Hex keys needed: #4 tap – 1/8", 2/0 tap – 5/16"
- Panel mountable: #10 (5 mm) fastener, torque to 25-30 in. lbs.

**Accessories:**

- Marker Strips to mark circuits. Printing available. Consult factory.

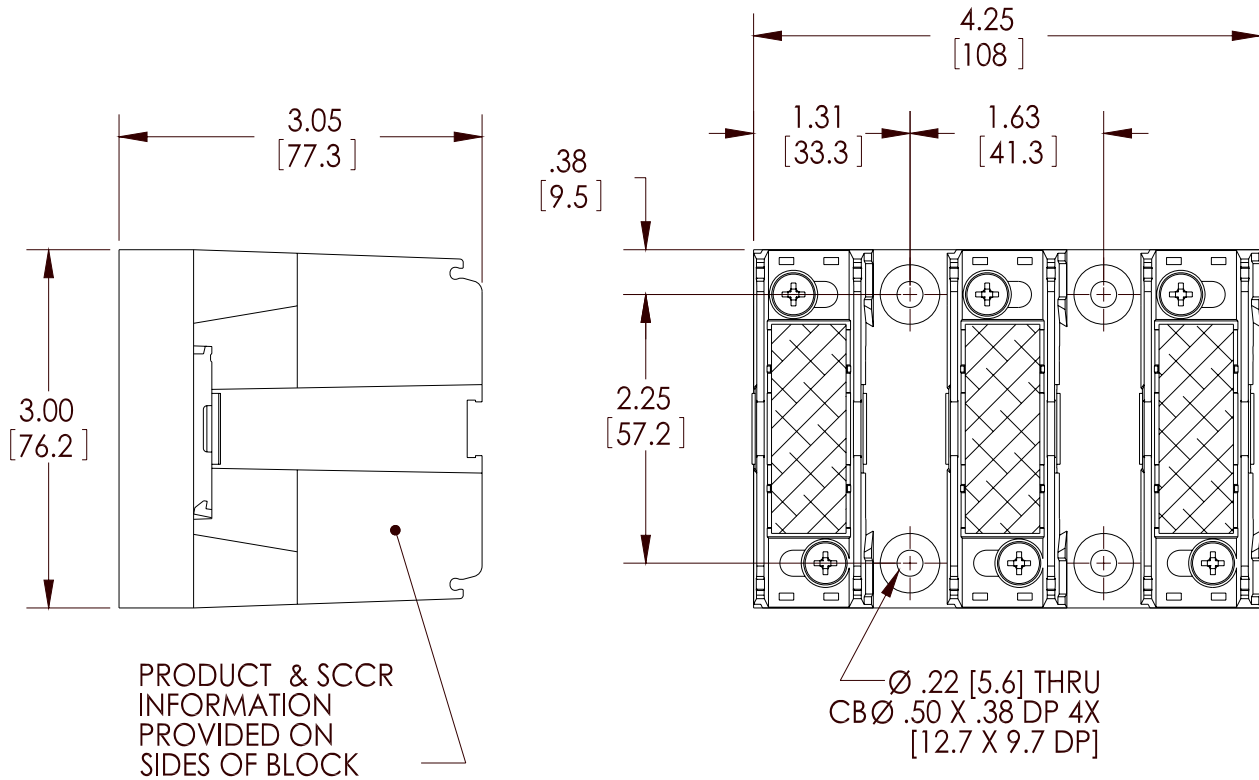

[WWW.MARATHONSP.COM](http://WWW.MARATHONSP.COM)  
1-419-352-8441