

Product Data Sheet



RHX0Q2L

Replace "X" with 2, 3, 4, 5 or 6 for number of poles

Reinforced Class H/K Fuse Panel 60 Amps, 250 Volts AC/DC



Wire Range:

Line Side : #2/0 - #14 AWG Copper, Aluminum
Load Side : #10 - #22 AWG Copper

[See table below for wire sizes.](#)

Holds fuse sizes: 13/16" diameter X 3"

Commonly used fuses in this holder: A2Y, CRN, NLN, NON, NRN, OT, OTN, RLN, RF

Electrical Ratings:

- 31 - 60A max (amperage rating based on maximum fuse rating for that physical size)
- 250 Volts AC/DC
- Approved for 10,000 Amp Withstand Rating

Mechanical Ratings:

- Insulator base temperature rating: -40°C/F to 150°C (302°F) UL RTI
- Flammability rating of insulator base: UL 94 V-0

Materials:

- Fuse Clips: Copper alloy, tin plated
- Bus Bar: High conductivity aluminum, tin plated
- Insulator base: phenolic
- Terminal set screws (Bus Bar): Aluminum, tin plated
- Connector mounting screws: Steel, zinc plated
- Bus Bar mounting screws: Steel, nickel plated

Agency Approvals:

- UL Recognized, Fuseholder standards UL 4248-1 and UL 4248-6.
- UL File No. IZLT2.E35113
- CSA Certified File No. LR21455
- CE compliant to IEC 60947-1
- RoHS Compliant

Wire Approvals:

Line Side:

Wire Size	Torque		Copper Wire Stranding Classes - Number of Conductors		
	N-m	In. lbs	Solid	Class B	Class C
2/0 AWG	13.6	120		1	1
1/0	13.6	120		1	1
1	13.6	120		1	1
2	13.6	120		1	1
4	13.6	120		1	1
6	13.6	120		1	1
8	4.5	40		1	1
10	4.0	35	1	1	1
12	4.0	35	1	1	1
14	4.0	35	1	1	1

Aluminum Stranded Wire Range: #2/0 - #14 AWG

Load Side:

Wire Size	Torque		Copper Wire Stranding Classes - Number of Conductors		
	N-m	In. lbs	Solid	Class B	Class C
10	2.8	25	1	1	1
12	2.8	25	1	1	1
14	2.8	25	1	1	1
16	2.8	25	1	1	1
18	2.8	25	1	1	1
20	2.8	25			
22	2.8	25		1	1

- Wire strip lengths: line side (bus bar) - 11/16"
- Hex key needed: 3/16"
- Panel mountable: #10 fastener, torque to 25-30 in. lbs.

Accessories:

Printing available: Consult customer service

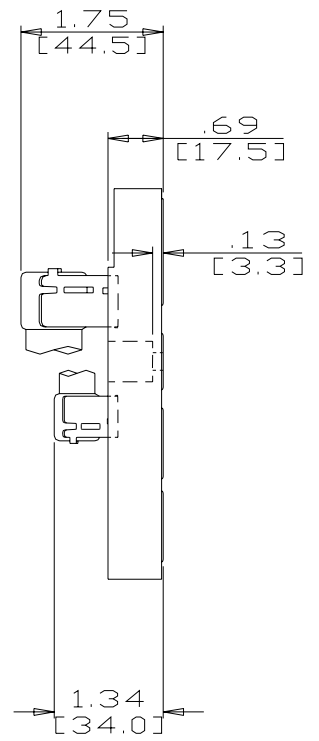
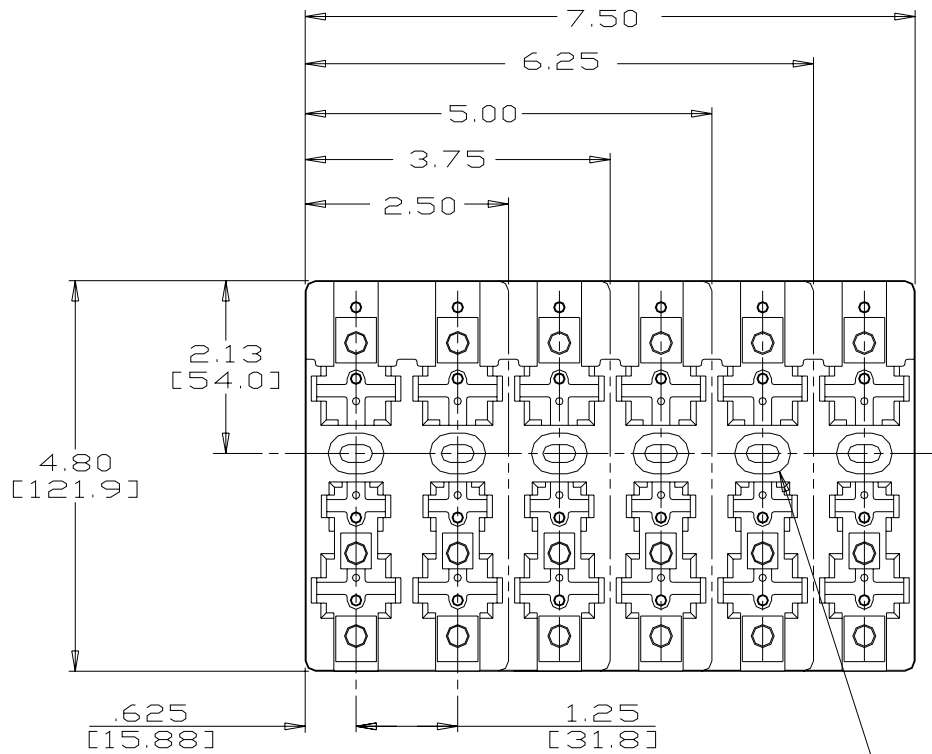

.22[5.6] X .41[10.4] HOLE
 .50[12.7] X .68[17.3] C'BORE
 X .55[14.0] DEEP

WWW.MARATHONSP.COM
 1-419-352-8441