



marathon™

Special Products

Power Blocks, Terminal Blocks,
Fuse Holders & Custom Products

2016 NEW Products



A Regal Brand

REGAL

Heavy Duty Terminal Block with Test Points

1500 TP SERIES

Marathon Special Products' "Testing Point" series addition brings new options to a very traditional product line by incorporating banana test jacks into the design of the original block. These test points allow panel builders and maintainers to efficiently test circuits on the fly without removing or adding hardware to the blocks.



FEATURES/BENEFITS

- Integral "Test Points" (TP) that enable connections with banana test leads in order to:
 - Perform control circuit testing
 - Make control circuit measurements
- Deep slotted screws to increase control of the screws when utilizing a screwholding screwdriver
- Thumb screws allow the cover and marker strip to be removed without removing the screws themselves
- Integral covers available to allow access to test points while maintaining dead-front touch protection
- Robust insulators to withstand and endure environmental and application wear

SPECIFICATIONS

- Compliant to UL and Canadian Standards
- 75A max with ring/fork terminals
- 30A max with bare wire
- 600V

APPLICATIONS

- Protection & control relay panels
- Utility power distribution

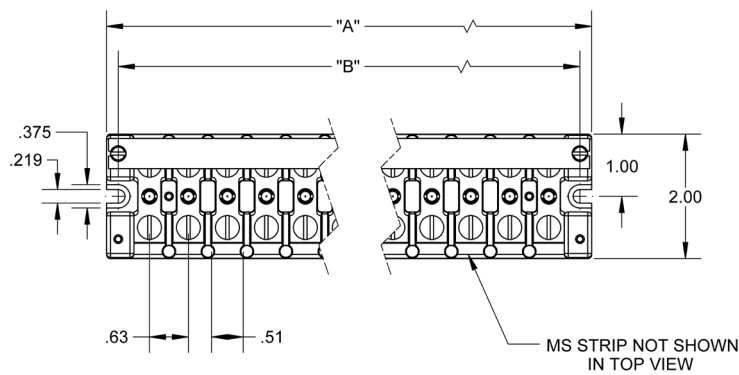

Catalog #	Description	"A"	"B"
1504TP	4-Pole with Test Points & MS	3.25	2.87
1506TP	6-Pole with Test Points & MS	4.50	4.12
1508TP	8-Pole with Test Points & MS	5.75	5.37
1512TP	12-Pole with Test Points & MS	8.25	7.87
CC15xxTP	Clear Cover (replace xx with No. of poles)		

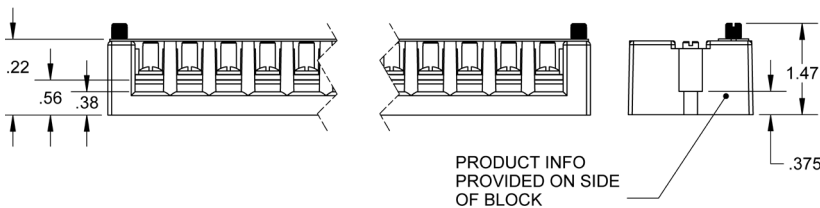

High Amperage UL Listed Enclosed Power Blocks

Marathon Special Products has once again added to our line of Listed Enclosed Power Blocks by adding three new 760A models to the series. The new models are in response to demand for more touch-safe versions of the traditional NEMA power block offerings, as well as UL Listing for feeder circuit compliance.

FEATURES and BENEFITS

- Accepts marker cards for individual circuit identification
- Modular construction for single or multiple pole configurations
- High SCCR (100kA) with fuse over-current protection
- Panel mountable with DIN rail clearance
- Feeder circuit compliant
- Compliant for flexible stranded wire classes

SPECIFICATIONS



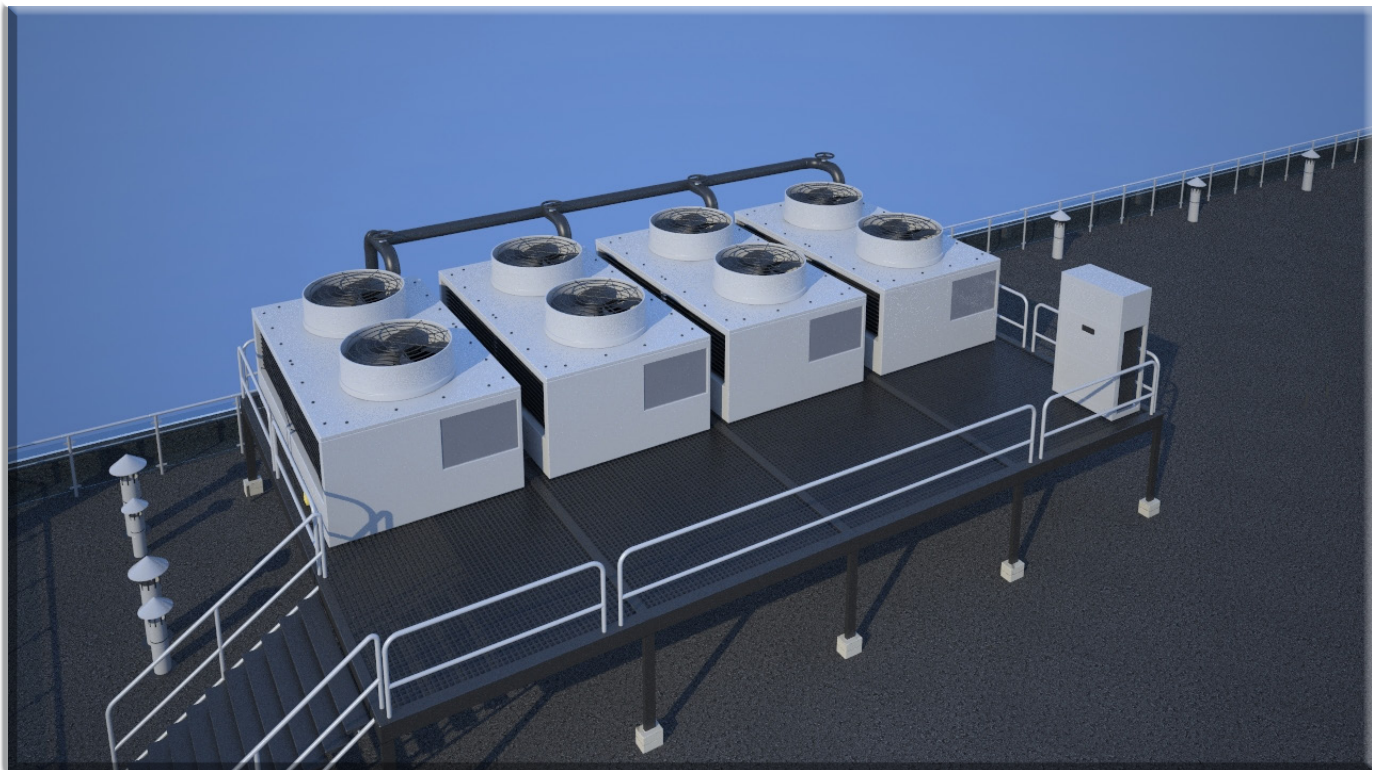

- Compliant to UL and Canadian Standards
- 600 Volts, up to 760 Amps
- IP20 touch protection

APPLICATIONS

- Industrial / Motor control systems
- Commercial HVAC
- Power distribution / generation

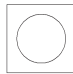
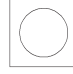
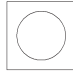
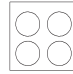
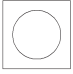
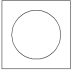
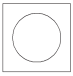
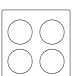

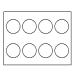
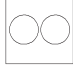
High Amperage UL Listed Enclosed Power Blocks

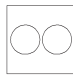
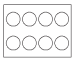
Amps	Cat #	Mounting Style	Max SCCR	Connector Material	LINE SIDE		LOAD SIDE					
					Wire Range AWG / kcmil	Connector Openings / Pole	Wire Range AWG / kcmil	Connector Openings / Pole				
115	EPBAD21	Both DIN / Panel	100,000	AL	#2 - #14	1 	#2 - #14	1 				
	EPBAD24	Both DIN / Panel	65,000	AL	#2 - #14	1 	#10 - #18	4 				
200	EPBAD42	DIN	100,000	AL	3/0 - #14	1 	3/0 - #14	1 				
	EPBAP42	Panel										
	EPBCD42	DIN	100,000	CU								
	EPBCP42	Panel										
	EPBAD45	DIN	100,000	AL	3/0 - #14	1 	#2 - #14	4 				
	EPBAP45	Panel										
	EPBCD45	DIN	100,000	CU								
	EPBCP45	Panel										
335	EPBAD74	DIN	10,000	AL	400 - #6 2/0 - #14	1/1 	#2 - #14	8 				
	EPBAP74	Panel	100,000									
	EPBCD74	DIN	10,000	CU								
	EPBCP74	Panel	100,000									
510	EPBAD71	DIN	10,000	AL	250 - #6	2 	250 - #6	2 				
	EPBAP71	Panel	100,000									
	EPBCD71	DIN	10,000	CU								
	EPBCP71	Panel	100,000									
760	EPBAP81	Panel	100,000	AL	500 - #4	2 	500 - #4	2 				
	EPBAP84			CU			2/0 - #14	8 				
	EPBCP84											



Enclosed Class J Fuse Holders

Marathon Special Products has redesigned our line of enclosed J Class holders to improve functionality, quality and compactness. The new design maintains the safety feature while improving ventilation and efficiency.

FEATURES and BENEFITS

- Blow fuse indicators standard
- Smallest profile among fuse carrier style enclosed Class-J holders
- Lock-out feature available to assure safety when changing fuses
- Multiple wire rated
- Snap-in marker strips for easy identification and marking

SPECIFICATIONS

- Compliant to UL and Canadian Standards
- Up to 30A & 60A, 600V
- IP20 touch-proof protection

APPLICATIONS

- Motor Overload Protection
- Industrial Control System
- Transformers



Catalog #	Amps	Poles	Base Materials	Wire Range
6SJ30AxI C	30	1 / 2 / 3	Thermoplastic	#1 - #18 AWG (2) #10 - #12 AWG
6SJ60AxI C	60			#1 - #14 AWG (2) #6 - #14 AWG
EFH-MCCK C		Ganging clips - used to group multiple fuse holders together as an assembly. Includes (10) handle pins and (20) body clips. Use one handle pin and two body clips per pole.		
MN35-2		Din rail - 35 x 7.5 x 200mm long, slotted		
MSK35		End bracket - for anchoring in place on din rail		

Modular Fuse Holder

Marathon Special Product's new modular fuse holder was developed to be compliant with a variety of bolt-down fuses from 125A to 800A. No other fuse holder available for specialty or semi-conductor fuses offers the dead front protection that the MFH delivers*.

Additionally, it is evaluated for high amp industrial fuses such as class J & T. This simple design provides a modern, yet cost effective solution for all of these fuse types.

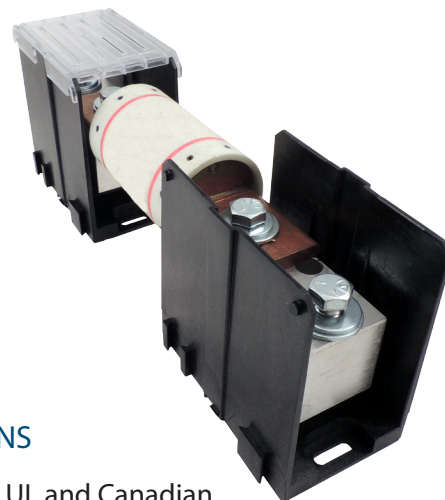

FEATURES and BENEFITS

- Compliant with a variety of fuse types, and evaluated at each fuse's SC withstand rating:
 - Industrial Class J & T
 - Semi-conductor
 - High Speed / Specialty
 - Photovoltaic
- Dead-front terminal protection with covers installed
- Snap-on translucent covers available
- Modular construction for single or multiple pole configurations
- Fastener connectors for mechanical or crimp lugs
- Evaluated to terminate flexible laminated bus bar

SPECIFICATIONS

- Compliant to UL and Canadian Standards
- 600V & 1500V versions
- Up to 800 amps

APPLICATIONS

- Motor / drive protection
- Industrial control systems
- Power distribution / generation

Catalog #	Amp	Voltage	Cover Included	For Fuse Types	Fuse Terminal	Line Side Terminal	Load Side Terminal
MFH6153DD CH	600	1500	Yes	Specialty / Semi-conductor / High-speed	3/8"Tap	3/8"Tap	3/8"Tap
MFH6153DD	600	1500	No				
MFH6063DD CH	600	600	Yes	J & T Class			
MFH6063DD	600	600	No				
MFH8155FF CH	800	1500	Yes	Specialty / Semi-conductor / High-speed	1/2"Tap	1/2"Tap	1/2"Tap
MFH8155FF	800	1500	No				
MFH8065FF CH	800	600	Yes	J & T Class			
MFH8065FF	800	600	No				

* Deadfront (with covers installed)

Custom Products

Developing custom products is why “special” is LITERALLY our middle name. Marathon Special Products’ core value is to provide quality solutions to meet our customers’ needs. We have the engineering and manufacturing capabilities to provide:

- Special hardware configurations to terminal blocks
- Special power block designs
- Special fuse holder designs
- Special terminal block designs for any application
- Special ratings that aren't available

Our product development team can quickly respond to your requests with the use of 3D modeling, finite element analysis, rapid prototyping and a UL approved test lab to accelerate the performance verification process for any testing requirements.

Please call or e-mail us
your request today!

419-352-8441
marketing@marathonsp.com

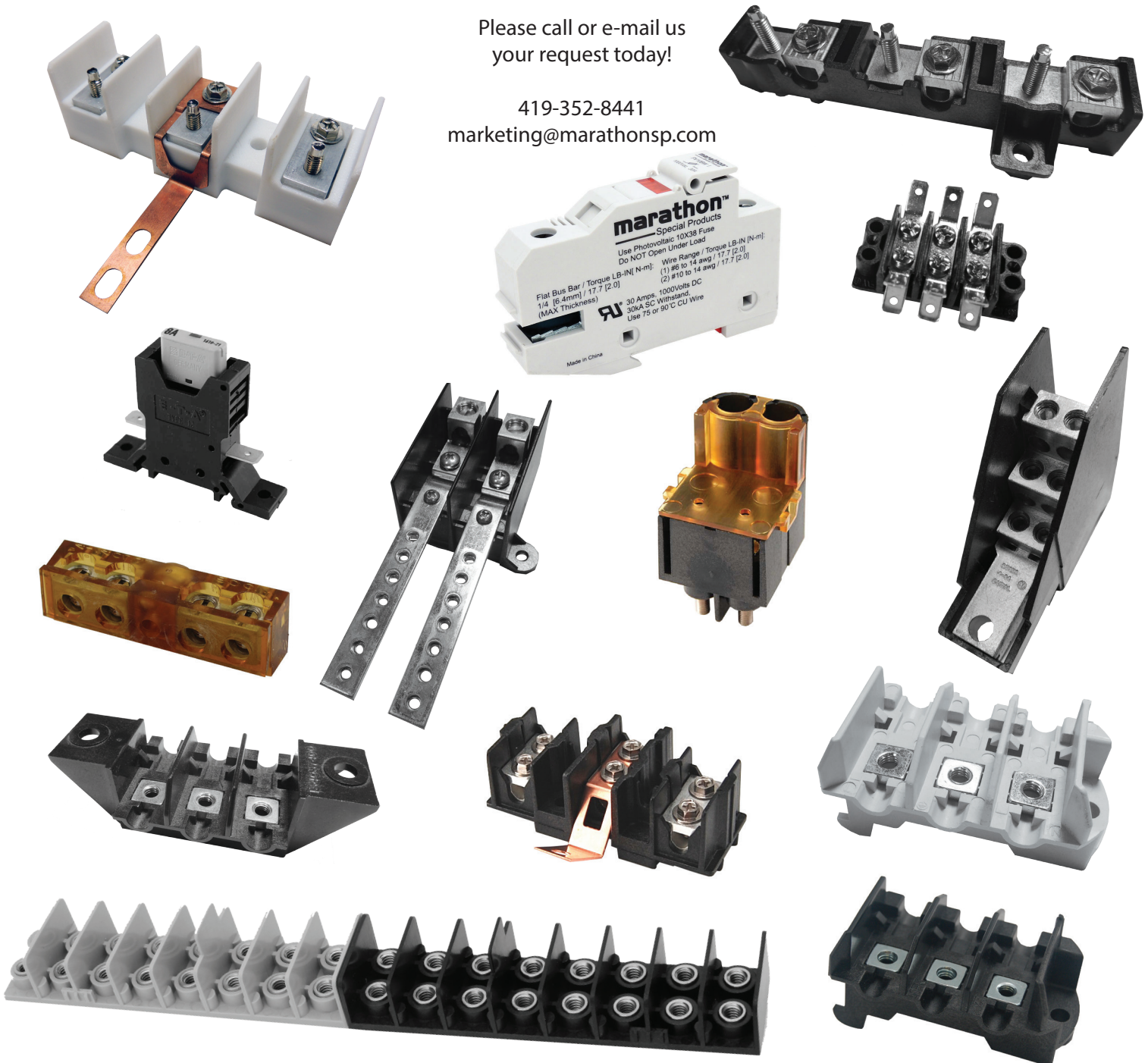

On February 1, 1994, Marathon Special Products was registered to ISO standards. We are currently registered to ISO 9001:2008 quality standards.

Agency Approvals:

The majority of products manufactured by Marathon Special Products are Underwriters Laboratories and Canadian Standards Association approved.



Environmental Compliance:

All products are RoHS compliant and do not require REACH notification.

Flexible Stranded Wire:

Various products have been investigated by UL for use with Flexible Stranded Wire. See product data sheets for more information.

Short Circuit Current Ratings:

Power Blocks have been tested and approved for higher Short Circuit Current Ratings (SCCR). The higher ratings are based on proper wire sizes and the appropriate circuit protection device (fuses or circuit breakers). UL 508A does allow default SCCR for Power Distribution Blocks of 10,000A with no additional testing.

Product Data sheets:

Detailed data sheets are available on www.marathonsp.com. These data sheets provide the user with complete application information including wire range, electrical ratings, mechanical ratings, short circuit current ratings (SCCR), agency and wire approvals, accessory information and drawings.



427 Van Camp Road
Bowling Green, OH
PH: 419-352-8441
FAX: 419-352-0875

www.marathonsp.com

A Regal Brand



www.regalbeloit.com