

JUMPERS; LINE-TO-LINE (J & JS) & MULTIPLE POSITION (RJ & RJS)

Material: Brass
Finish: Nickel Plate

J & JS JUMPERS



J JUMPER

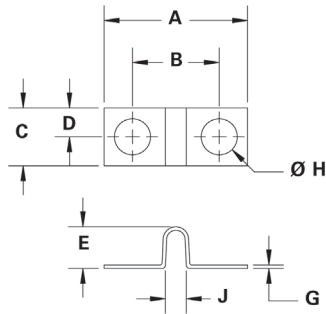

JS JUMPER

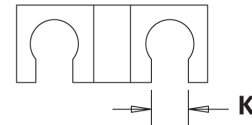

Available for:

- 3/8" (.375)
- 7/16" (.44)
- 9/16" (.567)

CATALOG #	DIMENSIONS								
	A	B	C	D	E	G	H	J	K
J 600	0.62	0.38	0.25	0.12	0.16	0.015	0.16	0.08	N/A
J 601	0.71	0.45	0.31	0.15	0.19	0.015	0.17	0.11	N/A
J 602	0.91	0.56	0.37	0.18	0.27	0.015	0.19	0.16	N/A
J 603	1.13	0.69	0.43	0.21	0.25	0.031	0.20	0.24	N/A
J 604	1.38	0.88	0.50	0.25	0.35	0.035	0.23	0.32	N/A
J 605	1.75	1.13	0.62	0.31	0.39	0.035	0.27	0.54	N/A
J 621 *	0.69	0.44	0.30	0.17	0.38	0.015	0.14	0.11	0.14
JS 600	0.62	0.38	0.25	0.12	0.16	0.015	0.16	0.08	0.16
JS 601	0.71	0.45	0.31	0.15	0.19	0.015	0.17	0.11	0.17
JS 602	0.91	0.56	0.37	0.18	0.27	0.015	0.19	0.16	0.14

NOTE 1: These parts are not necessarily supplied flat. The functioning of the part, however, will not be interfered.

NOTE 2: All dimensions are applicable after the bus (jumper) is torqued down into the associate terminal board.

* The J621 jumper is physically a JS style as illustrated, which is open on one side.

RJ TYPE JUMPERS

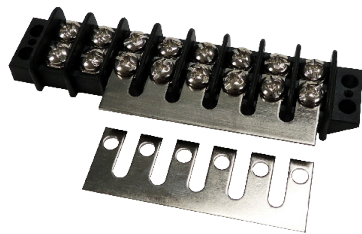

600 RJ
Available only for
Center to Center of .38" (3/8)

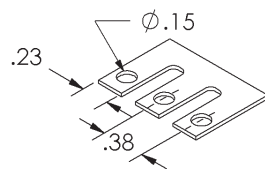

Max # of sections = 24

601 RJ
Available only for
Center to Center of .44" (7/16)

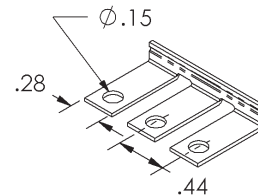

Max # of sections = 24

RJS TYPE JUMPERS



600 RJS

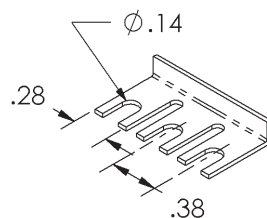

Max # of sections = 24

601 RJS

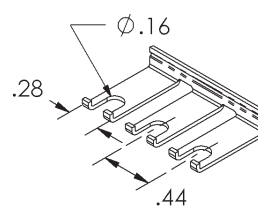

Max # of sections = 24